

Bitung-Ambon On MV AMBAI



- ✓ GREAT COMFORT, LARGE CABINS
- ✓ OPTIMAL DIVING EXPERIENCE
- ✓ EXCELLENT FOOD
- ✓ FRIENDLY ATMOSPHERE
- ✓ FREE NITROX

Number of dives

During your cruise you will perform a minimum of 42 dives:

- * 1 dive-guide/ 4 divers maximum (4 guides/16 divers)
- * Free nitrox for certified divers (possibility of certification on board)
- * 3 fibreglass tenders
- * Our great crew is at your service to carry your tank and gear



Visibility

Visibility can rapidly change. Commonly you can see 30 meters away, but visibility can diminish in certain areas or punctually.

Temperature

The temperature is all year long between 28° and 30°C. Long wetsuit 3 mm is recommended.

Currents

Halmahera is well known for its consistent currents that can be dangerous. Wallacea dive cruise has a real experience of the scuba diving sites. We pay very much attention to dive at the right place at the right time in order to avoid that uncomfortable and dangerous currents. Obviously before each dive, briefings will inform you about the diving conditions and advises will be given to always keep the dives safe. However, a strong scuba diving experience is required for this fabulous cruise. A reef hook can be useful.





WALLACEA
DIVE CRUISES



Manado

BITUNG

MAYU

TIFORE

NORTH
SULAWESI

HALMAHERA

MAKIAN

SIKO

TANATI

BACAN

DAMAR

MANDIOLI

PISANG

OBI

WEST
PAPUA

MOLUCCA SEA

HALMAHERA

Black tip,napo, big sweetlips, big red scorpion fish,nudis, crabs, Nice and quiet reef. Current at the surface.

Excellent reefs full of blooming orange soft corals packed with anthias, plenty of large soft coral covered bommies in all different colours and different species. Here we can expect some good currents which gives us the chance to see lots of reef sharks; black tip, white tip and grey reef sharks as well as many other pelagic

SERAM SEA

SERAM

Ambo

AMBON

BANDA SEA

SERUA

BANDA
NEIRA

The itinerary varies slightly between each cruise depending on weather conditions, currents, visibility and tides.







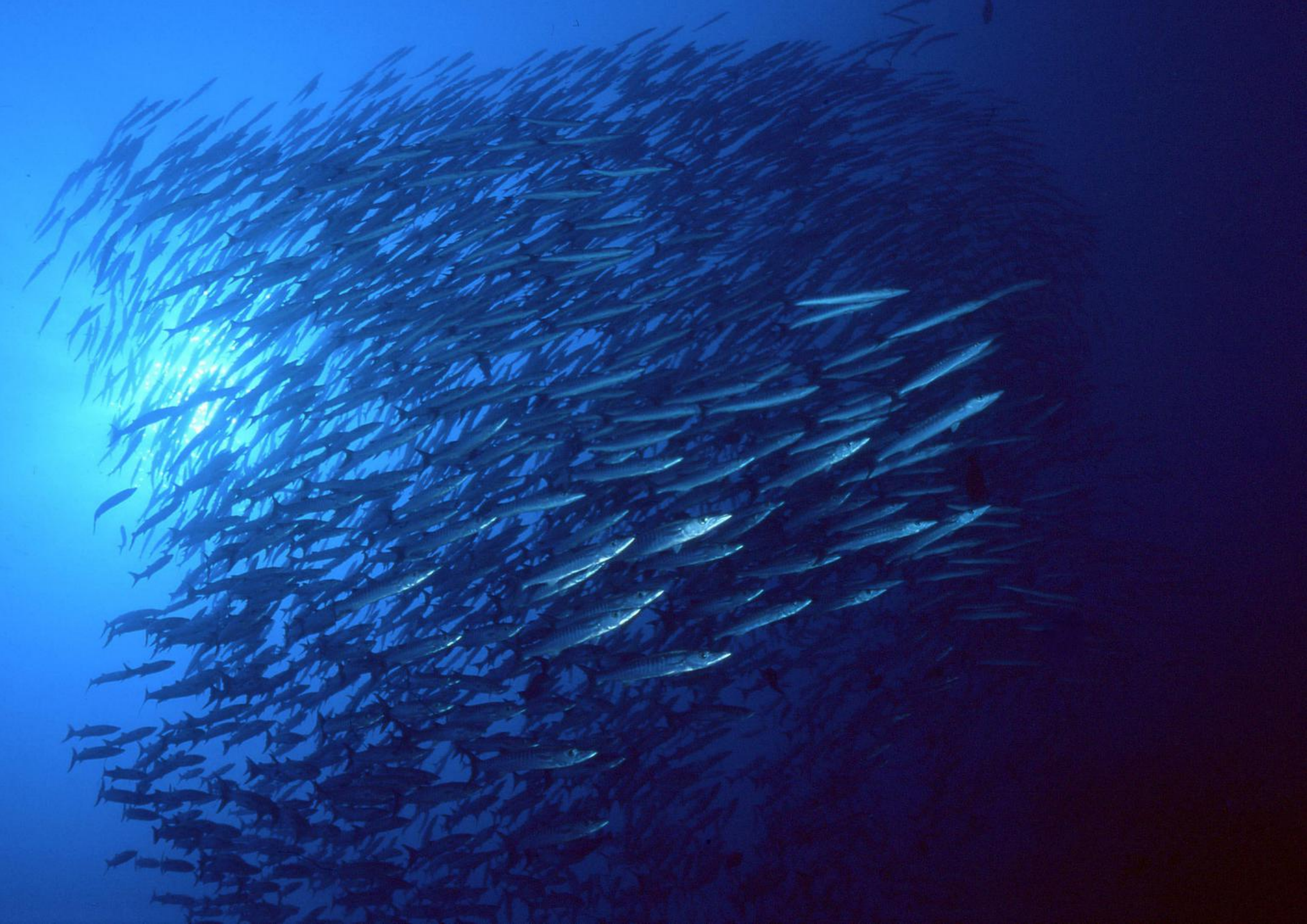

Domestic flights (international airport suggested: Jakarta but Manado is also an option)

Jakarta-Manado (Manado is Jakarta time + 1)

AIRWAYS	Jakarta-Manado	Rate	Luggage
 Garuda Indonesia <i>The Airline Of Indonesia</i>	11:00 - 15:30	€220	20 kg (+23 kg)
 Batik air	01:55 - 06:05 11:00 - 15:20	€90	20 kg (+3€/ Kg above)

Ambon-Jakarta (Ambon is Jakarta time +2)

AIRWAYS	Ambon-Jakarta	Rate	Luggage
 Garuda Indonesia <i>The Airline Of Indonesia</i>	08:20-11:20	€245	20 kg (+23 kg)
 Batik air	08:00-09:30	€95	20 kg (+2€/ Kg above)

NB possibility to fly outbound with one airline and come back with another one at no extra charge.

Ambai:Boat specifications

8 air-conditioned double bed Cabins with ensuite & hot water

* 32 m x 7,5 m

* 16 divers

* 12 crew members - 4 dive guides - 1 cruise director/instructor

* 4 cabins double bed and single bunk above, lower deck

* 2 cabins with single bunk, lower deck

* 2 cabins with double bed on the upper deck



4 versatile lower double/twin bed cabins (1,2,3,4)



2 upper deck double bed cabins (7,8)



2 lower deck twin bed cabins (5,6)

2 Spacious Lounges & 1 Restaurant boast a friendly feeling which assures your comfort!



1 camera room, 3 dinghies, 4 kayaks





Service

Behind the MV Ambai there is also and mainly a discreet, professional, smiling and friendly crew. Our team will treat you with some special attentions, will assist you if necessary and will carry your tank.

The cuisine

Mixing eastern and western specialties, our chef cuisine is a « fusion" that will never let you hungry. Shall you have specific inquiries, or a particular diet (vegetarian or banana allergy), our chef will adapt the meals for your greatest pleasure.

Layout of the Boat

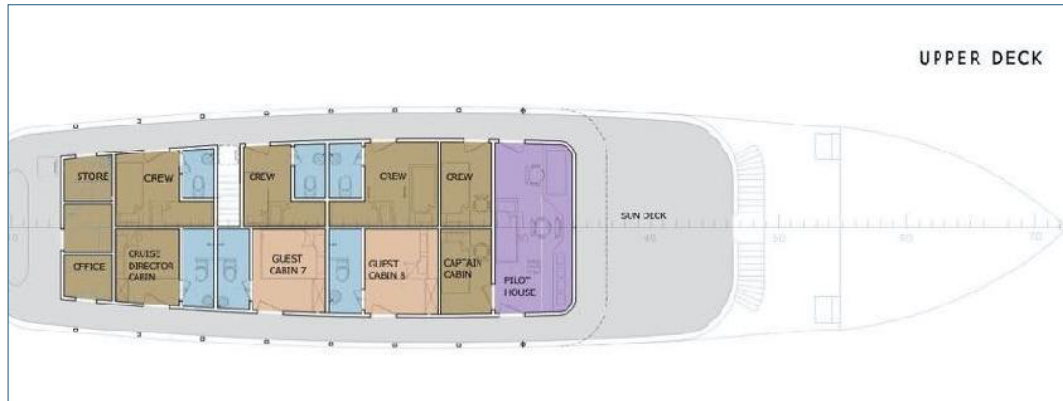

The team at your service

17 crew members
4 dive guides
1 skipper / diving instructor

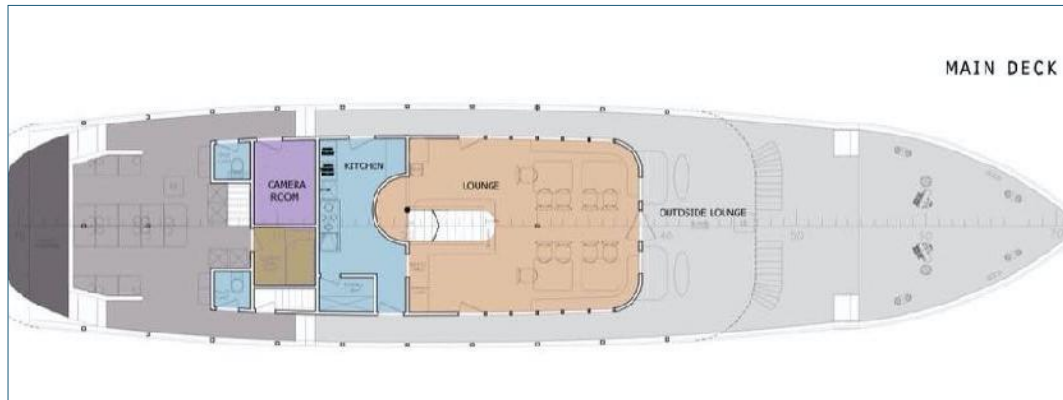

Technical part

Engine: 610 Hp Mitsubishi Navy 2012
Generators: Generators Yanmar 3 respectively 40, 28 and 16 kW, 2012
Fresh water: 10 tons of reserves and water-maker capacity 10 tons / day

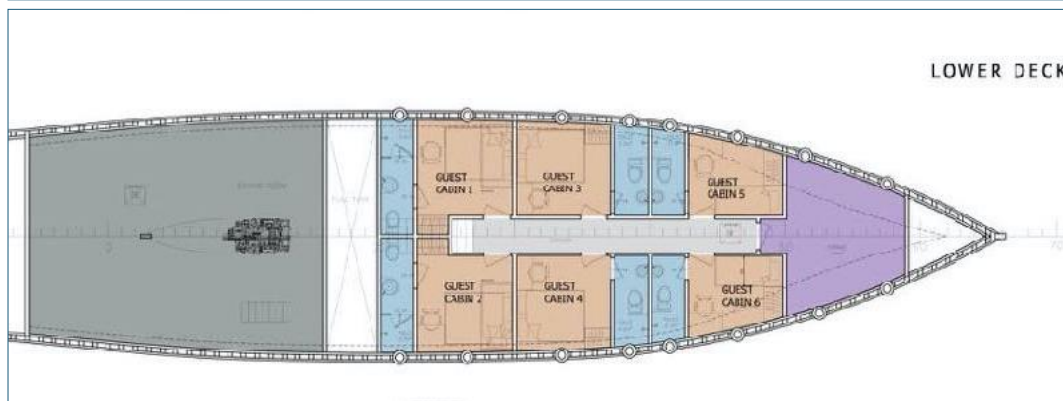

Compressors: air compressors 2 200 lts / min. Atlas-Copco low pressure compressor with membrane production NITROX.
Navigation: GPS, GPS Plotter, Echo sounder, Radar
Communication: Radio VHF, Radio UHF, satellite phone (+881632675145). Wifi if 3G available
Dinghies: 3 fibreglass speedboats 4-stroke 50Hp engine

Diving organisation on MV Ambai

Number of dives : 42 or more

- 1 Dive the day of departure
- 3 dives / day every day of the cruise
- 8 Night dives.
- 1 dive the day before disembarking, maybe 2 according to your flight schedule (24h/No FLY).

Schedule & standards

- 1st dive: 07:00am
- 2nd dive: 10:30am
- 3rd dive: 02:30pm
- Night dive: 06:30pm
- Dive time: 60 minutes
- Maximum Depth : 35 meters
- Dives into the safety curves
- Systematic safety stop

Due to the large number of dives and the remoteness of the location, we urge divers to stay within no-deco limits, to stay above a maximum depth of 35 meters, and to perform a safety stop at the end of every dive.

Depending on the guests' dive experience, interests (photography, macro, etc), and use of nitrox (free for certified divers), the Cruise Director will arrange the diving groups. These groups are made up of four divers max and a dive guide. The dive guides are rotated on a daily basis. Each diver is given a dive tank (DIN & INT available, no need for adapters) and their own dive station for the duration of the cruise.

A briefing will be conducted by the Cruise Director or one of the guides before each dive. It will describe the site topography, depths, currents and potential hazards, as well as the marine life we expect to encounter.

The staff carries your tank between the MV Ambai and the dinghies. Onboard the dinghies, tanks are placed in slots and the guide will help you to gear up just before you backroll into the water.

Identification books of flora and local fauna are available on board, and the dive guides or the Cruise Director will always help you identify that strange animal you just found underwater!

There is some dive equipment to rent on board: However, all sizes are not necessarily available, so please book it before the cruise.

* Our cruises are open to divers Padi Advanced Open Water or equivalent with at least 50 dives logged. Less experienced divers can also participate with special supervision that needs to be arranged before the cruise.

* Insurance covering medical evacuation and diving accidents is highly recommended. Divers will be filling out a statement of medical fitness for dive activities onboard.

* We expect you to carefully respect and protect the underwater world: have good buoyancy to avoid touching the reef or breaking any corals; do not touch the animals, do not collect anything; do not harass wildlife for photos and moderate the number of flashes you impose on them. The use of gloves is not allowed.

* Divers should always carry a surface marker buoy.

*Thank you to read our rules of diving [here](#). By booking a cruise with Wallacea you agree with these few basic rules.

The cruise rate

Includes

- Accommodation in a shared twin or double cabin.
- All meals & snacks. Drinking water, soft drinks and hot drinks
- All guided dives (1 guide /4 divers maximum)
- Nitrox
- Aluminium tank (12 litres), weights and belts
- Airport-boat transfers from/to the closest airport (departure and arrival).

Doesn't include

- Park, port & distance fees: 300 € (cash on board)
- International and domestic flights
- Alcoholic beverages (you can BYOB)
- Diving equipment rental (see pricing below)
- 100 cf (15 litres) tank : 65 € / cruise
- Laundry (1 € / 2 pieces)
- Crew gratuities
- Massage
-

Good to know

- All extras are payable in cash on board. We can not receive payment by credit card.
- Currencies accepted on board: €, USD, CHF, IDR.
- Tipping: they reflect **your** level of satisfaction with the service on board. As an indication in the area , this is 5%-10% of the cruise rate.
- Provided on board: towels and toiletries, soap, shampoo and toothpaste.
- Electrical outlets round European type.
- Room for storage and loading photos / videos and accessory devices with many outlets. Taken in the cabins and bathrooms also. Hair dryer available on request.
- Available on board: rods and hooks in stainless, € 15
- 4 complimentary Kayaks

**YOUR PASSPORT VALIDITY MUST BE AT LEAST 6 MONTHS
AFTER THE SCHEDULED RETURN DATE**

DIVING EQUIPMENT RENTAL RATES

• Complete regulator with octopus & pressure gauge	10€/ day
• BCD	10€/ day
• Wetsuit	10€/ day
• Torch	5€/ day
• Dive Computer	10€/ day
• Fin	5€/ day
• Diving mask	5€/ day

ADDITIONAL INFORMATION

Visa

Since May 2016, nationals from 169 countries are dispensed of visa and can enter the Indonesian territory for a maximum of 30 days (not renewable).

You can check the list of these countries by following this link :<http://www.topbali.com/indonesia-visa/>

Insurance

An insurance covering medical evacuation and diving accidents is compulsory. It will be requested upon arrival on board.

MV Ambai/MSY Seahorse schedules

[Komodo cruises](#)

[Raja Ampat cruises](#)

[Raja Ampat & Triton bay cruises](#)

[Ring of Fire & Banda sea cruise](#)

[Derawan Island cruises](#)

[Sulawesi cruises](#)

Check in - Check out

Check in: the cruise starting date, before 13:00 pm

Check out: at the cruise ending date, before 12:00 pm

SCHEDULE CRUISES

NOV- MAY
Raja-Ampat

JUN- SEP
Komodo/Derawan

SEPT-OCT
Banda Sea

OCT- NOV
ROF- Triton Bay

